



LISLE CORPORATION O.E.M. PRODUCTS DIVISION

BASIC MANUFACTURER OF SPECIALTY PRODUCTS FOR INDUSTRY





Lisle Corporation, located in southwest Iowa, “Where the Work Ethic Still Works”, has been dedicated to manufacturing quality products since 1903.

Today, we are recognized as a leading manufacturer of specialty automotive tools, mechanics’ creepers, drill sharpeners and a broad range of OEM products for industry. Our expanded OEM Division produces parts for heavy equipment, refrigeration, hydraulic systems, the trucking industry, the automotive industry and many others.

This catalog represents only part of the Lisle OEM Division product line. The pages that follow present those items that are either stock or standard parts. In addition, much of what we manufacture is unique to a specific customer. If you do not find a part cataloged that meets your requirements, please give us a call. Our OEM Division Sales and Engineering Departments will work with you to provide the quality parts you need.

Lisle Corporation has the engineering and manufacturing capabilities to design and produce a wide range of precision parts. We are not limited to magnetic devices or components. Our manufacturing experience covers a broad spectrum and those capabilities are available to you for even modest sized jobs.

MAGNETIC PLUGS

Magnetic Drain Plugs were pioneered by Lisle Corporation in the 1930's. Lisle magnetic plugs are similar to standard pipe or straight thread drain plugs with one important difference — a permanent magnet is fastened to the plug body. This magnet attracts and holds abrasive, ferrous metal particles preventing their circulation through the lubrication or hydraulic system.

These abrasive, ferrous metal particles appear in lubricating or hydraulic systems as a result of the following conditions:

- The constant flaking effect of normal wear of moving parts.
- Particles not removed by flushing operations after boring or machining.
- Chipping due to sub-surface casting flaws.
- Minute component breakdown caused by stress usage.

Usually a combination of factors accounts for the presence of these particles that cause excessive wear to vital components unless they are removed. By holding these particles, Lisle magnetic drain plugs prevent excessive wear to the system's components.

Lisle manufactures magnetic plugs in a wide variety and range of sizes, magnet types, and body styles. Lisle magnetic plugs are used by numerous manufacturers of gear boxes, transmissions, engines, and hydraulic systems for the automotive, agricultural and machinery industries. Typical applications include:

- | | |
|------------------------------------------------------------------------------------------------------------------------------------------------------------------------------------------------------------------------------------------------------------------------------------------------------------------------------------------------------------------------------------------------------------------------------------------------------------------------------------------------------------|------------------------------------------------------------------------------------------------------------------------------------------------------------------------------------------------------------------------------------------------------------------------------------------------------------------------------------------------------------------------------------------------------------------------------------------------------------|
| <ul style="list-style-type: none"> • Air Conditioning and Refrigeration Compressors • All Terrain Vehicles • Balers • Combines • Crawler Tractors • Diesel Engines • Drilling Equipment • Earthmoving Equipment • Farm Tractors • Garden Tractor Engines • Heavy-Duty Transmissions • Hoists and Cranes • Hydraulic Systems • Lawnmower Engines • Lift Trucks | <ul style="list-style-type: none"> • Military Vehicles • Mining Equipment • Motorcycle Transmissions and Engine • Oil Well Equipment • Outboard Engines • Printing Presses • Pumps • Recreational Vehicles • Snowmobiles • Speed Reducers and Gear Boxes • Tiller Engines • Trans-Axles • Truck Axles • Turbine Engine |
|------------------------------------------------------------------------------------------------------------------------------------------------------------------------------------------------------------------------------------------------------------------------------------------------------------------------------------------------------------------------------------------------------------------------------------------------------------------------------------------------------------|------------------------------------------------------------------------------------------------------------------------------------------------------------------------------------------------------------------------------------------------------------------------------------------------------------------------------------------------------------------------------------------------------------------------------------------------------------|

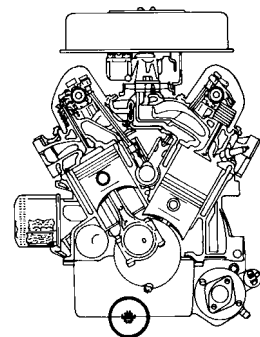
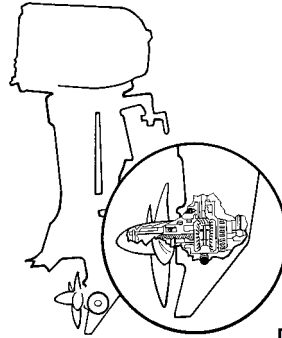

Engines

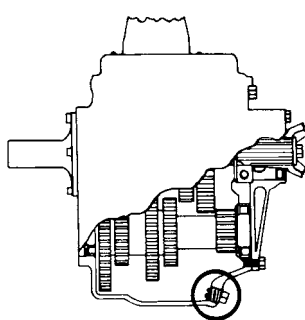

Transmissions

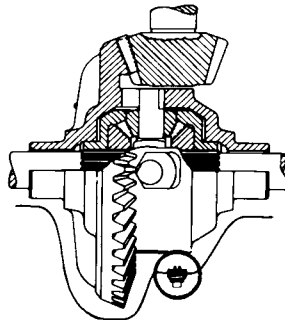

Gear Boxes



Before



After



Deep Reach



Pipe Thread

PIPE THREAD

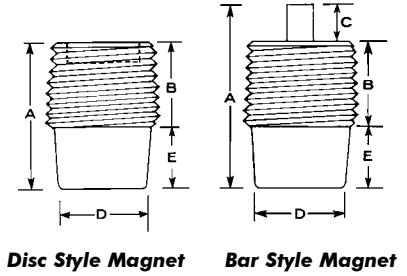

Disc Style Magnet

Bar Style Magnet

SQUARE HEAD

Nominal Pipe Size	Part Number	Magnet Style & Material	A		B Overall Body Length		C		D		E		Body Material
			Length	in. mm	in. mm	in. mm	in. mm	in. mm	in. mm	in. mm			
• 1/8"-27 NPTF	4016011	Neodymium	.94	23.9	.38	9.7	.32	8.1	.27	6.9	.24	6.1	Steel
• 1/4"-18 NPTF	4026011	Neodymium	.96	24.4	.45	11.4	.23	5.8	.37	9.4	.28	7.1	Steel
1/4"-18 NPTF	4024031	Bar Ceramic V	.95	24.1	.50	12.7	.15	3.8	.37	9.4	.28	7.1	Steel Zinc Plate Yellow Chromate
• 3/8"-18 NPTF	4036011	Neodymium	1.05	26.7	.50	12.7	.23	5.8	.44	11.2	.31	7.9	Steel
• 3/8"-18 NPTF	4034031	Disc Ceramic I	.80	20.3	.47	11.9	-	-	.43	10.9	.34	8.6	Steel
• 1/2"-14 NPTF	4044041	Disc Ceramic I	.96	24.4	.57	14.5	-	-	.56	14.2	.38	9.7	Steel
• 3/4"-14 PTF	4054121	Disc Ceramic I	1.11	28.2	.62	15.7	-	-	.62	15.7	.45	11.4	Steel
3/4"-14 PTF	4054121	Bar Ceramic I	1.30	33.0	.62	15.7	.23	5.8	.62	15.7	.45	11.4	Steel
• 1"-11 1/2 NPTF	4064021	Disc Ceramic I	1.52	38.6	.75	19.1	-	-	.81	20.6	.52	13.2	Mall. Iron
1"-11 1/2 NPTF	4064031	Bar Ceramic I	1.59	40.4	.76	19.3	.25	6.4	.81	20.6	.52	13.2	Mall. Iron
• 1 1/4"-11 1/2 NPTF	4074041	Disc Ceramic I	1.37	34.8	.81	20.6	-	-	.94	23.9	.56	14.2	Cast Iron
• 1 1/2"-11 1/2 NPTF	4084011	Bar Ceramic I	1.85	46.9	.97	24.6	.25	6.4	1.12	28.4	.62	15.7	Cast Iron
• 2"-11 1/2 NPTF	4094051	Bar Ceramic I	1.81	45.9	.88	22.3	.25	6.4	1.37	34.7	.68	17.2	Cast Iron

• Standard parts supplied from stock or with minimum lead-time.

MAGNET COMPARISON

	ENERGY ¹ PRODUCT	TEMPERATURE STABILITY	RESISTANCE TO DEMAG	COST
Ceramic I	1.0	Good	Excellent	Low
Ceramic V	3.5	Good	Excellent	Medium
Alnico V	5.5	Excellent	Good	Medium
Neodymium	30.0	Good ²	Excellent	High ²

¹ Energy Product gives an indication of magnetic energy available in a given volume of magnetic material.

² Temperature stability and price vary with the grade of material.

PIPE THREAD



Pipe Thread

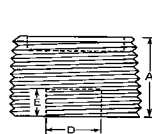

Disc Style Magnet

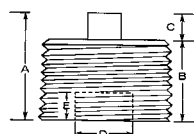

Bar Style Magnet

SQUARE RECESSED

Nominal Pipe Size	Part Number	Magnet Style & Material	A Overall Nominal Length		B Body Length		C Magnet Projection		D Head Size		E Head Depth		Military Body Material	Spec. Number
			in.	mm	in.	mm	in.	mm	in.	mm	in.	mm		
• 1/2"-14 NPTF	5044051	Disc Ceramic I	.60	15.2	.60	15.2	-		.38	9.7	.31	7.9	Steel	
• 3/4"-14 NPTF	5054051	Disc Ceramic I	6.2	15.7	.62	15.7	-		.51	13.0	.31	7.9	Steel	
• 3/4"-14 NPTF	5054181	Bar Ceramic I	.90	22.9	.62	15.7	.28	7.1	.51	13.0	.31	7.9	Steel	
• 1"-11 1/2 NPTF	5064071	Disc Ceramic I	.77	19.6	.77	19.6	-		.51	13.0	.40	10.2	Steel	
• 1 1/4"-11 1/2 PTF	5074061	Bar Ceramic I	1.33	33.8	1.08	27.4	.25	6.4	.51	13.0	.38	9.7	Mall. Iron	
1 1/2"-11 1/2 NPTF	5084021	Bar Ceramic I	1.20	30.5	.83	21	.37	9.3	.81	20.6	.57	14.1	Grey Iron	

• Standard parts supplied from stock or with minimum lead-time.

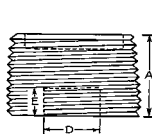

Disc Style Magnet

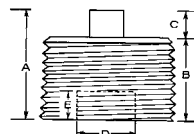

Bar Style Magnet

HEX RECESSED

Nominal Pipe Size	Part Number	Magnet Style & Material	A Overall Nominal Length		B Body Length		C Magnet Projection		D Head Size		E Head Depth		Military Body Material	Spec. Number
			in.	mm	in.	mm	in.	mm	in.	mm	in.	mm		
• 1/8"-27 NPTF	5016031	Neodymium	.79	20.1	.37	9.4	.42	10.7	.19	4.8	.12 min.	3.0	Steel	
• 1/4"-18 NPTF	5026021	Neodymium	.84	21.3	.46	11.7	.38	9.7	.25	6.4	.19 min.	4.8	Steel	MS490006-4
• 3/8"-18 NPTF	5036011	Neodymium	.82	20.8	.46	11.7	.36	9.1	.31	7.9	.19 min.	4.8	Steel	MS490006-6
• 3/8"-18 NPTF	5034011	Disc Ceramic I	.52	13.2	.46	11.7	.06	1.5	.31	7.9	.19 min.	4.8	Steel	MS490006-6
• 1/2"-14 NPTF	5046021	Neodymium	1.00	25.4	.61	15.5	.37	9.4	.38	9.7	.25 min.	6.4	Steel	MS490006-8
• 1/2"-14 NPTF	5044121	Disc Ceramic I	.61	15.5	.61	15.5	-		.38	9.7	.25 min.	6.4	Steel	MS490006-8
• 3/4"-14 NPTF	5056031	Neodymium	.84	12.3	.62	15.7	.19	4.8	.56	14.2	.31 min.	7.9	Steel	MS490006-10
• 3/4"-14 NPTF	5054121	Disc Ceramic I	.62	15.7	.62	15.7	-		.56	14.2	.31	7.9	Steel	MS490006-10
• 1"-11 1/2 NPTF	5066021	Neodymium	.99	25.1	.77	19.6	.19	4.8	.63	16.0	.38 min.	9.7	Steel	MS490006-12
• 1"-11 1/2 NPTF	5064041	Disc Ceramic I	.77	19.6	.77	19.6	-		.63	16.0	.38 min.	9.7	Steel	MS490006-12

• Standard parts supplied from stock or with minimum lead-time.

STRAIGHT THREAD

Industrial Type for General Use

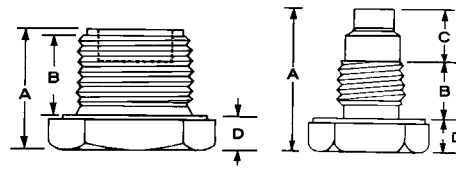

Disc Style Magnet

Bar Style Magnet



Straight Thread

CAP SCREW TYPE

Thread Size and Class	Part Number	Magnet Style & Material	A Overall Nominal Length		B Thread Length		C Magnet Projection		D Head Thickness		Body Material	Finish	Military Spec. Number		
			in.	mm	in.	mm	in.	mm	in.	mm					
3/8"-24 UNF2A	7246011	Neodymium	.75	19.1	.30	7.6	.25	6.4	.62	15.7	.19	4.8	Steel	Zinc Plate	MS35844-1
3/8"-24 UNF2A	7242171	Bar Alnico	1.00	25.4	.30	7.6	.50	12.7	.62	15.7	.19	4.8	Aluminum	Anodize	MS35844-2
• 1/2"-20 UNF3A	7306011	Neodymium	.87	22.1	.34	8.6	.32	8.1	.75	19.1	.22	5.6	Steel		
1/2"-20 UNF2A	7302541	Bar Alnico V	1.03	26.2	.34	8.6	.50	12.7	.75	19.1	.19	4.8	Steel	Zinc Plate	MS35844-49
5/8"-18 UNF2A	7366011	Neodymium	.78	19.8	.38	9.7	.19	4.8	.87	22.1	.21	5.3	Steel		
5/8"-18 UNF2A	7362211	Bar Alnico V	.87	22.1	.38	9.7	.25	6.4	.87	22.1	.25	6.4	Steel	Zinc Plate	MS35844-3
3/4"-16 UNF2A	7402431	Bar Alnico V	.89	22.6	.37	9.4	.31	7.9	.93	23.6	.21	5.3	Steel		
3/4"-16 NF2	7406021	Neodymium	1.00	25.4	.38	9.7	.19	4.8	.94	23.9	.44	11.2	Steel		
3/4"-16 UNF2A	7402351	Bar Alnico V	.92	23.4	.41	10.4	.25	6.4	1.00	25.4	.26	6.6	Steel	Zinc Plate	MS35844-83
• 3/4"-16 UNF2A	7404011	Disc Ceramic I	.75	19.1	.41	10.4	-	-	1.00	25.4	.25	6.4	Steel		
7/8"-14 UNF2A	7454071	Disc Ceramic I	.77	19.6	.41	10.4	-	-	1.12	28.4	.25	6.4	Steel	Zinc Plate	MS35844-5
7/8"-18 UNS2A	7472121	Bar Alnico V	.91	23.1	.41	10.4	.25	6.4	1.12	28.4	.25	6.4	Steel	Zinc Plate	MS35844-99
• 7/8"-18 NS2	7474041	Disc Ceramic I	.78	19.8	.40	10.2	-	-	1.12	28.4	.21	5.3	Steel		
1"-14 NS3	7524011	Bar Ceramic I	1.06	26.9	.50	12.7	.25	6.4	1.31	33.3	.31	7.9	Steel		
1"-18 UNS2A	7542011	Bar Alnico V	1.25	31.8	.44	11.2	.50	12.7	1.25	31.8	.31	7.9	Steel	Zinc Plate	MS35844-111
• 1"-18 NS2	7544021	Disc Ceramic I	.89	22.6	.40	10.2	-	-	1.25	31.8	.31	7.9	Steel		
1 1/8"-12 UNF2A	7604011	Disc Ceramic I	1.15	29.2	.53	13.5	-	-	1.50	38.1	.37	9.4	Steel		
1 1/8"-16 UN2A	7614021	Disc Ceramic I	.94	23.9	.56	14.2	-	-	1.37	34.8	.38	9.7	Steel		
1 1/4"-12 UNF3A	7634011	Bar Ceramic I	1.18	30.0	.62	15.7	.25	6.4	1.62	41.1	.31	7.9	Steel	Zinc Plate	

• Standard parts supplied from stock or with minimum lead-time.

STRAIGHT THREAD



Flange Type Straight Thread

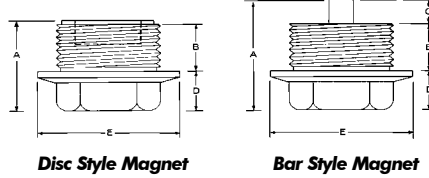

Disc Style Magnet

Bar Style Magnet

FLANGE TYPE

Thread Size and Class	Part Number	Magnet Style & Material	A Overall Nominal Length		B Thread Length		C Magnet Projection		D Hex Across Flats		E Flange Diameter		Body Material	Finish
			in.	mm	in.	mm	in.	mm	in.	mm	in.	mm		
1"-16 N-2	6534011	Disc Ceramic I	.87	.87	.45	.45	-	-	.20	.20	1.25	1.25	Steel	
			22.1	22.1	11.4	11.4	-	-	5.1	5.1	31.8	31.8		
1 5/8"-12 UN-2A	6754011	Disc Ceramic I	1.00	1.00	.58	.58	-	-	.32	.32	1.88	1.88	Steel	
			25.4	25.4	14.7	14.7	-	-	8.1	8.1	47.7	47.7		
2"-12 UN-2A	6792021	Bar Alnico V	1.38	1.38	.56	.56	-	1.50	.82	1.50	2.25	2.25	Mall. Iron	Cad. Plate
			35.1	35.1	14.2	14.2	-	38.1	20.8	1.50	20.8	57.2		

These are standard parts but not stock...allow lead-time for delivery.

METRIC THREAD



Metric Thread

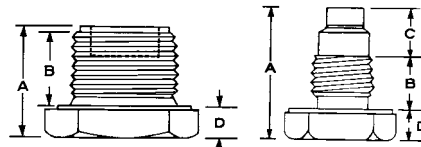

Disc Style Magnet

Bar Style Magnet

METRIC THREAD

Industrial Type for General Use.

Thread Size and Class	Part Number	Magnet Style & Material	A Overall Nominal Length		B Thread Length		C Magnet Projection		D Hex Across Flats		E Diameter		Flange Body Style	Body Material	Finish
			in.	mm	in.	mm	in.	mm	in.	mm	in.	mm			
M12 X 1.25	6786011	Neodymium	1.05	1.05	.49	.49	.19	.19	.55	.55	.31	.31	Flange Type	Steel	Zinc
			26.7	26.7	12.5	12.5	4.8	4.8	14	14	7.9	7.9			
M12 X 1.75	6996011	Neodymium	1.64	1.64	.50	.50	.21	.21	.59	.59	.39	.39	Flange Type	Steel	
			41.7	41.7	12.7	12.7	5.33	5.33	15	15	9.9	9.9			
M14 X 1.25	7894011	Disc Ceramic I	.75	.75	.53	.53	-	-	.75	.75	.22	.22	Cap Screw	Steel	Phosphate Coating
			19.1	19.1	13.5	13.5	-	-	19.1	19.1	5.6	5.6			
M18 X 1.5	6384021	Disc Ceramic I	1.06	1.06	.50	.50	-	-	.75	.75	.55	.55	Flange Type	Steel	Zinc
			26.9	26.9	12.7	12.7	-	-	19.1	19.1	14	14			
M22 X 1.5	7174011	Disc Ceramic I	.75	.75	.55	.55	.04	.04	.55	.55	.16	.16	Internal Hex	Steel	Zinc
			19.1	19.1	14	14	1	1	14	14	4.01	4.01			

These are standard parts but not stock...allow lead-time for delivery.

DEEP-REACH ASSEMBLIES

Lisle Deep-Reach Assemblies are designed to provide magnetic protection for large capacity lube or hydraulic systems. Greater magnetic capability is accomplished by stacking several magnets on a post or inside a thin stainless steel or brass tube. This type of construction projects the chip collection area farther into the system and closer to the areas of chip generation.

When ferrite magnets are stacked on a post, the steel washers that form the magnetic "sandwich" not only protect the magnets, they concentrate the magnetic field for more efficient chip collection and retention. The springs used as spacers serve as shock absorbers. This type of construction has proven to be both rugged and economical.

In instances where it is impractical to install conventional magnetic plugs or deep-reach plugs, Lisle engineers can design special magnetic assemblies to provide large areas of magnetic protection.

Post length, number of magnets, and thread size can be altered to make a part ideal for your application. A sketch indicating the size of the reservoir and areas of greatest contamination will provide Lisle engineers with the information necessary to design a part to meet your specific requirements.



Deep-Reach Assemblies

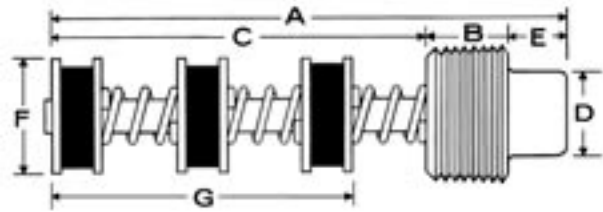

Deep-Reach Style

DEEP-REACH TYPE

Thread Size	Part Number	Magnet Style & Material	A Overall Nominal Length		B Thread Length		C Magnet Projection		D Head Size		E Head Height		F Magnet Diameter		G Magnet Working Length		Body Material
			in.	mm	in.	mm	in.	mm	in.	mm	in.	mm	in.	mm	in.	mm	
• 3/4"-14 NPTF	4057031	3-Disc Ceramic I	4 3/16	5/8	3	5/8	7/16	7/8	2 1/4	Steel							
			106.3	15.9	76.2	15.9	11.1	9.7	57.2								
• 1"-11 1/2 NPTF	4067171	3-Disc Ceramic I	4 1/4	3/4	3	13/16	17/32	7/8	2 1/4	Cast Iron							
			108.0	19.1	76.2	20.6	13.5	9.7									
1"-11 1/2 NPTF	8064071	6-Disc Ceramic I	8 3/32	3/4	6 13/16	13/16	17/32	7/8	4 7/8	Cast Iron							
			205.5	19.1	173.0	20.6	13.5	9.7	123.8								
• 1 1/4"-11 1/2 NPTF	4077061	3-Disc Ceramic I	4 11/32	13/16	3	15/16	17/32	7/8	2 1/4	Cast Iron							
			110.3	20.6	76.2	23.8	13.5	9.7	57.2								

- Standard parts supplied from stock or with minimum lead time.

PORTHOLE VIEW GAUGES

These view gauges are designed for multiple uses and are made for insertion, into els, tees, or other N.P.T. fittings and are easily installed and removed with a wrench. These rugged units are turned from solid hexagon material and come with a clear glass window firmly held between two gaskets.

Recommended maximum pressures, listed below, allow safe margins for variations in application and installation.

CLEAR WINDOW WITH OPEN BACK

PSI	A Stock Thread	B Stem Length	C Body Length	D Sight Diameter	E Assembly Clearance	LISLE Item Number
steel, zinc plated						
75	3/8-18	1/2	11/32	15/32	1	9037011
75	1/2-14	17/32	7/16	37/64	1 1/4	9047011
50	3/4-14	17/32	7/16	3/4	1 1/2	9057011
25	1-11 1/2	11/16	1/2	1	1 13/16	9067011
10	1 1/4-11 1/2	11/16	1/2	1 9/32	2 1/4	9077011
10	1 1/2-11 1/2	11/16	1/2	1 9/32	2 1/2	9087011

CLEAR WINDOW WITH REFLECTOR BACK

PSI	A Stock Thread	B Stem Length	C Body Length	D Sight Diameter	E Assembly Clearance	LISLE Item Number
steel, zinc plated						
75	1/2-14	17/32	7/16	37/64	1 1/4	9047021
20	3/4-14	17/32	7/16	3/4	1 1/2	9057021
25	1-11 1/2	11/16	1/2	1	1 13/16	9067021
10	1 1/4-11 1/2	11/16	1/2	1 9/32	2 1/4	9077021
10	1 1/2-11 1/2	11/16	1/2	1 9/16	2 1/2	9087021

DOMED VIEW GAUGE

Oil level is easy to read from any angle. Outer dome is clear, unbreakable plastic. White plastic inner dome makes oil level stand out in dim light.

steel, zinc plated					Item Number
3/4-14	17/32	13/16	15/16	1 1/2	9057031
1-11 1/2	11/16	13/16	15/16	11 3/16	9067031
11/4-11 1/2	11/16	1	1 1/4	2 1/4	9077031



Porthole View Gauges

▲ WARNING:

Do not exceed
listed PSI and/or 250° F.
Not for air service.

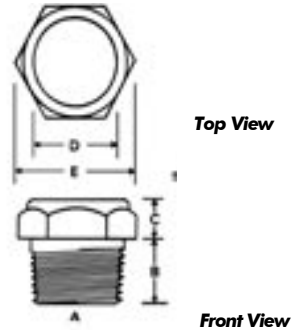

Clear Window View Gauge

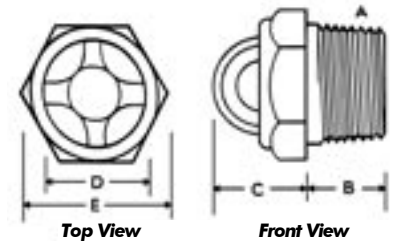

Domed View Gauge

▲ WARNING:

Do not exceed
10 PSI up to 100° F
or 2 PSI up to 160° F.
Not for air service.

BREATHER VENTS

These breathers are designed for rugged industrial applications. They are designed to maintain safe, equalized pressure in a unit even when it is being filled or under sudden changes in ambient temperature. You have a choice of non-filtered which permits straight through flow of air or filtered which has a screen and two layers of Nylon for filtration.

NON-FILTERED BREATHER VENTS				
steel, zinc plated				
A	B	C	THREAD	OPEN VENT
1 9/32	1/2	5/8	1/8-27 NPT	8017011
1 11/32	3/4	7/8	1/4-18 NPT	8027031
1 11/32	3/4	7/8	3/8-18 NPT	8037021
1 15/32	7/8	1	1/2-14 NPT	8047031

FILTERED BREATHER VENTS				
steel, zinc plated				
A	B	C	THREAD	FILTER
19/32	1/2	5/8	1/8-27 NPT	8017021
111/32	3/4	7/8	1/4-18 NPT	8027041
111/32	3/4	7/8	3/8-18 NPT	8037031
115/32	7/8	1	1/2-14 NPT	8047041



Breather Vents

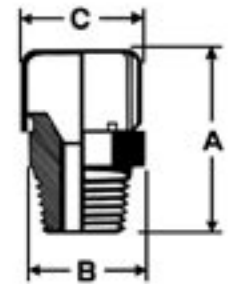

Non-Filtered Breather Vent

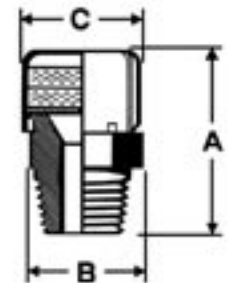

Filtered Breather Vent

ON/OFF ROAD HEAVY EQUIPMENT



Deep-Reach Assemblies

CATERPILLAR[®]



Komatsu Dresser
Company

STEMCO[®]



Specialty Switch Assembly



Plugs (Sight & Bolt Assembly)



Hydraulic Control Unit

NACCO Materials Handling

TRANSMISSIONS/HYDRAULIC



Magnetic Plugs



Magnetic Plug Screen Assemblies



Dipsticks

EATON®

CLARK® Material Handling Company



Special Breather

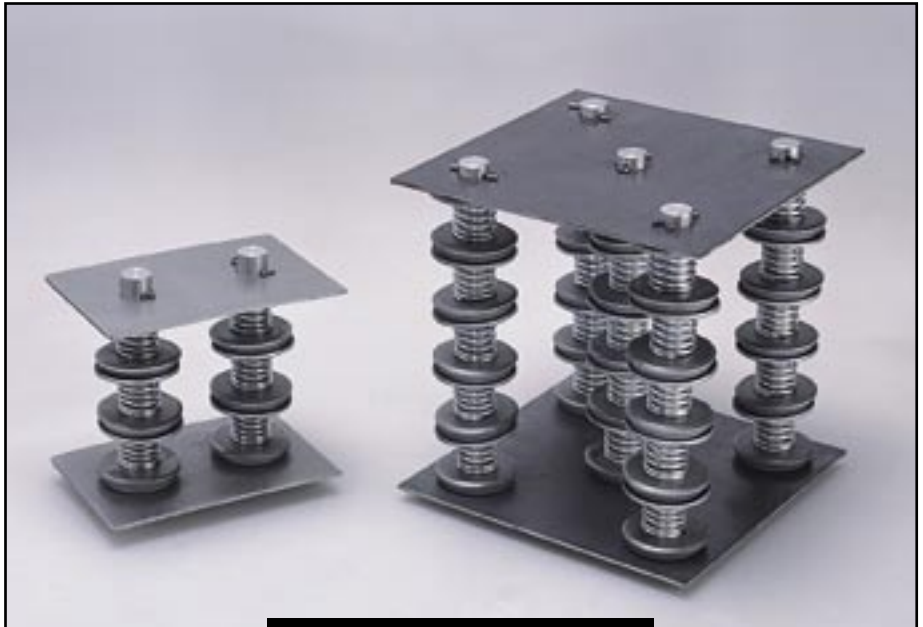

Magnetic Assemblies

REFRIGERATION/OTHER



Screen Assemblies & Magnetic Plugs

POLARIS®

Carrier®

TUTHILL
CORPORATION



Special Units



Chip Collectors



Special Magnetic Units

STANDARD & SPECIAL MAGNETIC UNITS



Magnetic Plugs



Special Magnetic Units



Special Unit



Magnetic Plug with Screen Assembly



Magnetic Plug Screen Assemblies

TECUMSEH®

FREIGHTLINER®
FREIGHTLINER CORPORATION

Copeland®

LISLE MANUFACTURING CAPABILITIES

DO YOU HAVE COST, QUALITY OR DELIVERY PROBLEMS WITH ASSEMBLIES?

The preceding pages have cataloged our Magnetic Plugs and Specialty Items. Through the years, as our product lines have grown and evolved, so have our manufacturing and engineering capabilities. These varied capabilities allow us to be competitive over a broad range of manufacturing and assembly procedures. In particular we specialize in jobs requiring multiple secondary operations and assembly.

LET US TAKE A LOOK AT YOUR "PROBLEM" ASSEMBLIES

If you are experiencing cost, quality or delivery problems, we invite you to submit your "problems" to us for quotation. Chances are good we'll be able to provide a solution.

WHAT DOES ALL THIS MEAN TO YOU?

Lisle Corporation, its people, plant and equipment plus its years of experience are ready to work for you...solving your manufacturing problems.

Let's get together and see how we can be of service. Just send us a print or sample and we'll promptly respond.





Lisle Corporation
OEM Products Division
807 E. Main Street • P.O. Box 89
Clarinda, IA 51632-0089
(712)542-5101 • Fax (712)542-4902
www.lislecorp.com/oem

