



## NEW TOOLS

### 44880 LIFT SUPPORT CLAMP WITH MAGNET



Holds Gas Charged Lift Supports Up to 9/16", Found on Hoods, Tailgates, Hatchbacks and Trunks. Neodymium Magnet Holds the Tool in Place While Securing the Clamp.

The clamp securely holds weak lift supports in the extended position. This allows access to engine compartment or rear luggage area. The aluminum body and brass threads prevent damage to the lift support shaft. The colorful flag is a reminder to remove the clamp before using.

**44880 Universal Lift Support Clamp.** Skin-packed. Shipping wt. 4 oz.

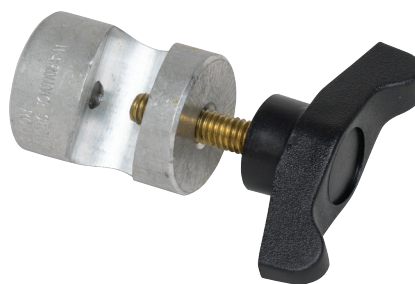

### 34720 INJECTOR SEAL INSTALLER KIT, 8 PC.



Used for Replacing Teflon Seals on Most Hitachi, Bosch, Continental and Delphi Single and Double Sealed Fuel Injectors Found on Many Ford, GM and Subaru Engines.

It also works on many Ford ECO injectors with direct injectors. The pilot cone is placed onto the end of the injector, and the seal is started over the cone. The installer is used to push the seal over the remainder of the cone and into the groove on the injector tip. The sizer is then placed over the seal to compress it back to the correct OD to allow installation into the cylinder head. Applications include: 2010 and later GM engines including 1.4L, 1.5L, 2.0L, 2.4L, 2.5L, 3.0L, 3.6L, 4.3L, 5.3L, and 6.2L. 2010-2017 GM 2.0L, 2.5L, 3.6L, 5.3L & 6.2L engines. 2014-2019 Subaru 2.0L & 2.4L turbo engines. Ford injectors 2011 and newer.

**34720 Injector Seal Installer Kit, 8 pc.** Molded case. Shipping wt. 9 oz.

**34630 Seal Pusher**                      **34640 Injector Seal Resizer for Ford, .312**

**34650 Injector Seal Resizer, .310**    **34670 Seal Stretcher, .160**

**34680 Seal Stretcher, .250**            **34690 Seal Stretcher, .330**

**34700 Seal Stretcher, .408**            **34710 Seal Stretcher, .430**

**34780 Case for 34720**



### 59560 STRETCH BELT TOOL FOR GM



Double Sided Design Allows the Tool to Work on Both A/C and Main Drive Pulleys When Installing Stretch Belts on GM 5.3L, 6.2L, and 6.6L Gas Engines.

The long tab is used on the A/C belt found on 2014 and newer GM trucks. The short tab can be used on the main drive belt found on 2019 and newer GM. Heat treated steel provides added strength. Black oxide finish.

**59560 Stretch Belt Tool for GM.** Skin-packed. Shipping wt. 7 oz.



## 89580 ATLASTA® ULTRASOFT BRUSH

Ultra Soft detailing brush has an Even Softer Tip than the Popular Atlasta® SoftTip Brush.

Clean polished surfaces, chrome, or clear coat without scratching. The bullet-shaped tip brush resists mushrooming to keep cleaning power at the tip for tight spaces and hard-to-reach spots. Long-lasting Trialoy® filament holds shape in both water and solvent-based cleaning solutions.

**89580 Atlasta® UltraSoft Brush.** Skin-packed. Shipping wt. 5 oz.



## 89160 LISLE CREW SOCKS, BLACK

Comfortable Crew Socks Made from Super Soft Bamboo Fibers.

Better moisture wicking than cotton, to prevent friction, reducing the chances of blisters and irritation.

**89160 Lisle Crew Socks, Black.** Label. Shipping wt. 4 oz.

